

**Key Features:**

- Frequency range: 3.4~4.8GHz, full band operation
- SMA connectors
- Small size, low cost
- Power handling +10 Watts Forward, and +2Watts Reverse

**Electrical Specifications**

Part No.	Freq Range MHz	Insertion Loss, dB	Reverse Isolation, dB	VSWR	Forward Power, Watts	Reverse Power Watts	Temp. Range, °C
F2128-0380-21	3.40-4.20	0.4 Max	20	≤ 1.25	10	2	-30 ~ +60
F2128-0410-34	3.40-4.80	0.5 Max	19	≤ 1.30	10	2	-30 ~ +60

**Mechanical Structure:**

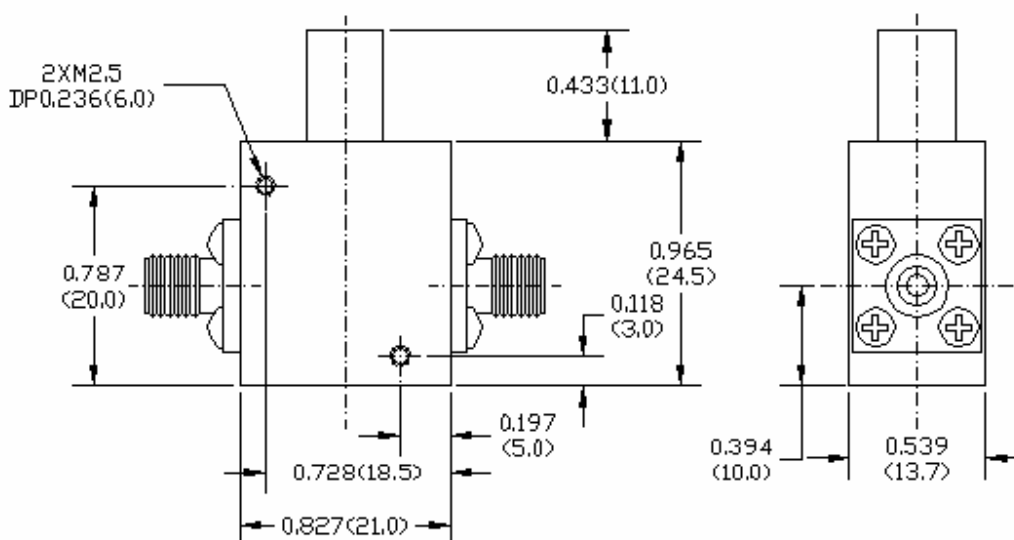

Note: All units are in inches (mm).

**Ordering Information:**

