

**Key Features:**

- Wide frequency range: 2000-8000MHz full band
- 50 ohm SMA coaxial connectors
- Small size, low cost
- Power handling +10 Watts forward and reverse
- Operating temperature -20~+70°C

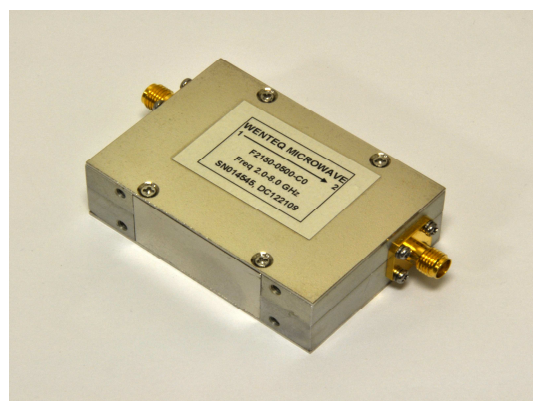

**Electrical Specifications**

Part No.	Freq Range GHz	Insertion Loss, dB	Reverse Isolation, dB	VSWR	Forward Power, Watts	Reverse Power, Watts	Temp. Range, °C
F2150-0500-C0	2.00-8.00	1.6 Max	≥ 11	≤ 1.9	≥ 10	>10	-20 ~ +70

**Mechanical Structure:**

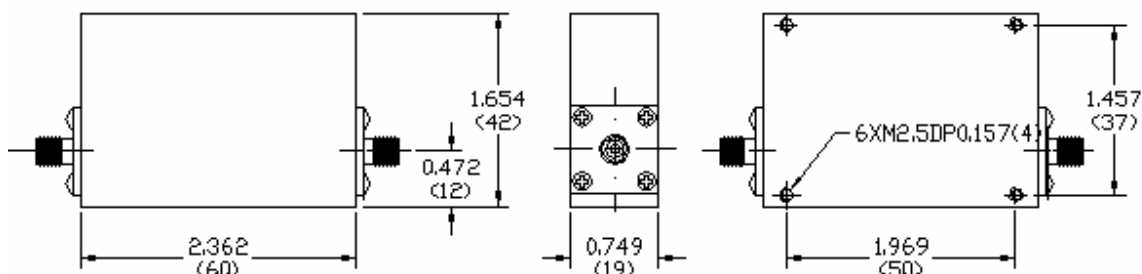

Note: All units in inches.

**Ordering Information:**

