

Key Features:

- Frequency range: 500~1000MHz, full band operation
- Small size, low cost
- 50 ohm SMA female I/O
- Power handling +10 Watts CW,
- Operating temperature -30~+65°C

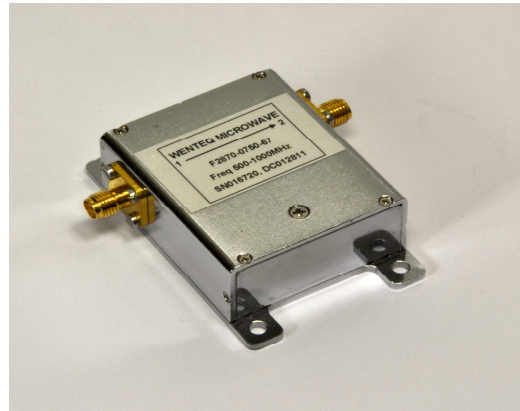

Electrical Specifications

| Part No. | Freq Range MHz | Insertion Loss, dB | Reverse Isolation, dB | VSWR | FW Power, Watts | Rev. Power Watts | Temp. Range, °C |
|---------------|----------------|--------------------|-----------------------|-------|-----------------|------------------|-----------------|
| F2370-0630-51 | 470-790 | 1.2 Max | ≥ 15 | ≤ 1.5 | 10.0 | 1.0 | 0 ~ +50 |
| F2370-0750-67 | 500-1000 | 1.5 Max | ≥ 14 | ≤ 1.6 | 10.0 | 10.0 | -30 ~ +65 |

Mechanical Structure:

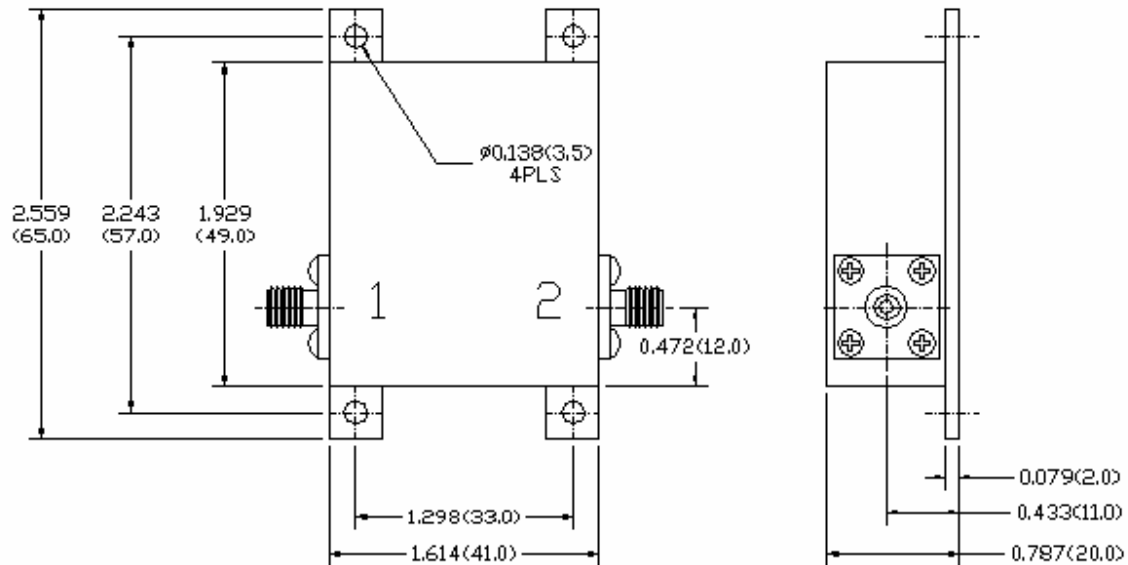

Note: All units in inches (mm).

Ordering Information:

