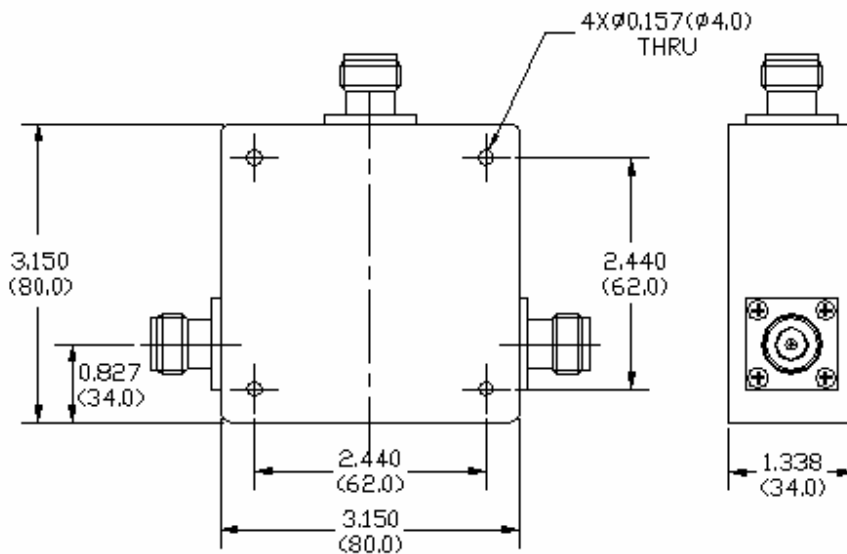

**Key Features:**

- Wide frequency bandwidth,
- N-Type female Connectors,
- low insertion loss, good reverse isolation
- High power handling capability,

**Electrical Specifications**

Part No.	Freq Range MHz	Insertion Loss, dB	Reverse Isolation, dB	VSWR	Forward Power, Watts	Temp. Range, °C
F2519-0262-29	225~300	0.6 Max	18	1.35	250	0 ~ +85
F2519-0280-29	240~320	0.5 Max	18	1.35	250	0 ~ +85

**Mechanical Structure:****Ordering Information:**

F2519-XXXX-XX  
                  ↓                  ↓  
                  Bandwidth, XX%,  
                  ↓  
                  Frequency 0XXX MHz,