

**Key Features:**

- Frequency range: 15.0~22.0GHz, bandwidth up to 1000MHz
- WR-51 waveguide, compact size
- Power handling 16Watts CW, 16kW pulse
- Good magnetic shielding
- Customer specify center frequency and bandwidth

**Electrical Specifications**

Part No.	Freq Range GHz	Insertion Loss, dB	Reverse Isolation, dB	VSW R	Power, Watts CW/Pulse	Temp. Range, °C
F3208-1600-06	15.5~16.5	0.30 Max	≥ 20	≤1.2	16W/16kW	-20 ~ +70
F3208-1650-06	16.0~17.0	0.30 Max	≥ 20	≤1.2	16W/16kW	-20 ~ +70
F3208-1800-05	17.5~18.5	0.30 Max	≥ 20	≤1.2	16W/16kW	-20 ~ +70

**Environment Specifications:**

- 1) Environment Magnetic: X- axis: 6 Gauss, Y-axis: 40 Gauss, Z-axis: 10 Gauss
- 2) Altitude: 0 ~ 30,000 ft

**Mechanical Structure:**

- 1) Body: Aluminum
- 2) Waveguide: WR-51
- 3) Flange: WR51 Cover
- 4) All dimension in mm

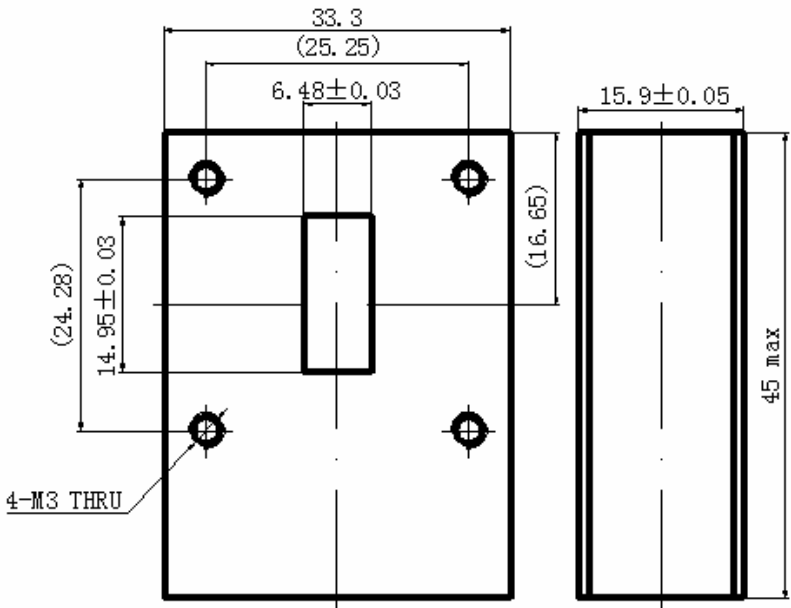

All units in mm

Ordering Information:

F3208-XXXX-XX  
                  ↓                  ↓  
                  Bandwidth, XX%,  
Frequency XX.XX GHz,